

**PROJECT LOCATION**

**NEARBY RESTROOMS**

NO.	DATE	REVISIONS	BY	CHECKED

**OVERALL PARK CONCEPT PLAN**  
**MICHAEL J. TIGHE PARK**

**FULLY-INCLUSIVE & ACCESSIBLE PLAYGROUND**  
**BLOCK 84, LOTS 16, 18 & 20**

TOWNSHIP OF FREEHOLD ENGINEERING DEPARTMENT  
 MONMOUTH COUNTY, NEW JERSEY  
 1 MUNICIPAL PLAZA  
 FREEHOLD, NJ 07728

DATE: JAN. 14, 2025  
 SCALE: 1"=500'  
 DRAWING: CONCEPT  
 SHEET: 1 OF 2

**MATTHEW J. BRYANT, P.E.**  
 TOWNSHIP ENGINEER  
 LICENSED PROFESSIONAL ENGINEER  
 STATE OF NEW JERSEY LICENSE NO. 24GE05240400  
 DESIGNED BY: MJB DRAWN BY: JKT CHECKED BY: MJB

1/14/25



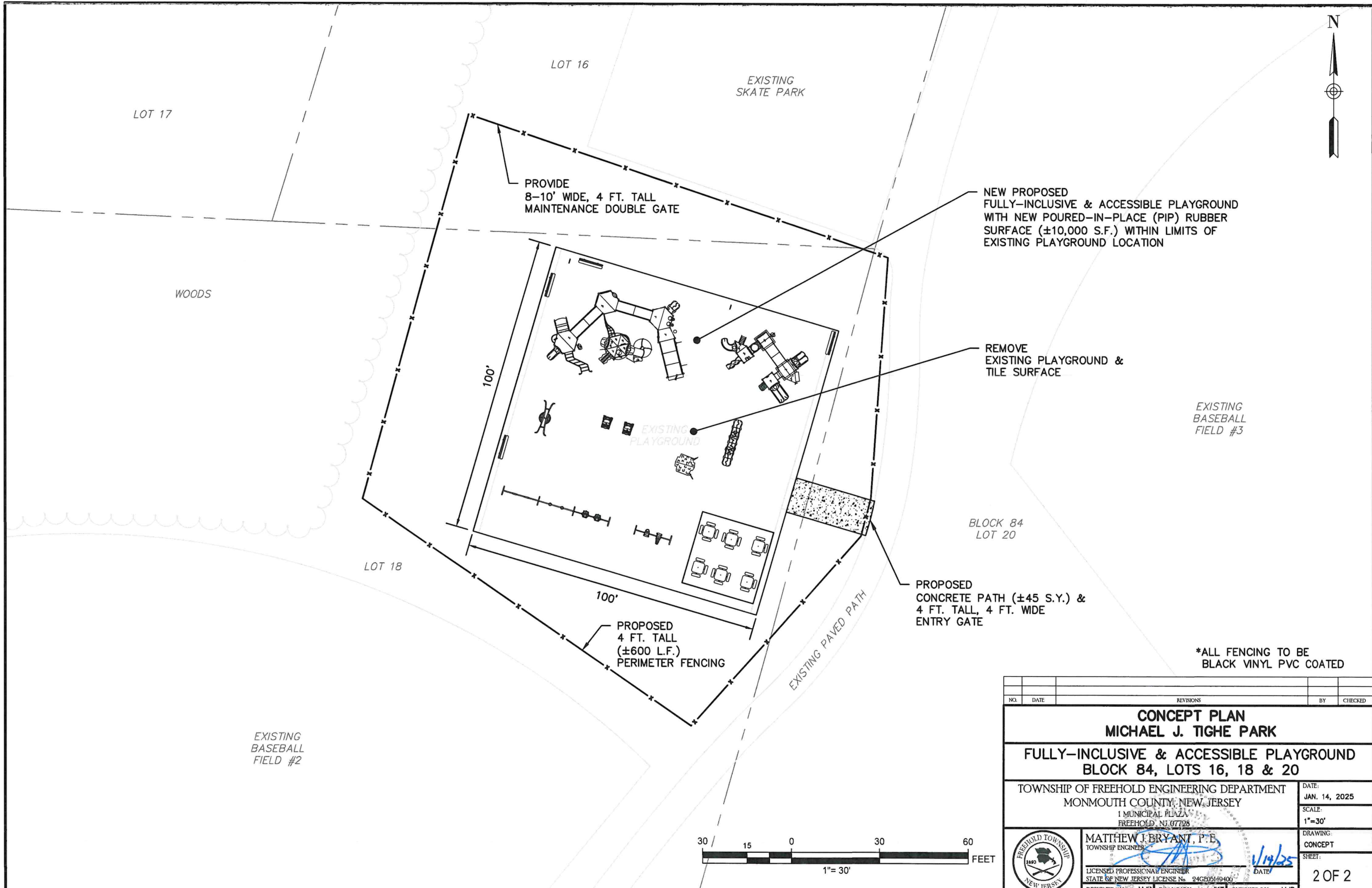

NEW PROPOSED FULLY-INCLUSIVE & ACCESSIBLE PLAYGROUND WITH NEW POURED-IN-PLACE (PIP) RUBBER SURFACE (±10,000 S.F.) WITHIN LIMITS OF EXISTING PLAYGROUND LOCATION

REMOVE EXISTING PLAYGROUND & TILE SURFACE

PROPOSED CONCRETE PATH (±45 S.Y.) & 4 FT. TALL, 4 FT. WIDE ENTRY GATE

PROVIDE 8-10' WIDE, 4 FT. TALL MAINTENANCE DOUBLE GATE

PROPOSED 4 FT. TALL (±600 L.F.) PERIMETER FENCING

EXISTING BASEBALL FIELD #3

BLOCK 84 LOT 20

\*ALL FENCING TO BE BLACK VINYL PVC COATED

NO.	DATE	REVISIONS	BY	CHECKED
<b>CONCEPT PLAN MICHAEL J. TIGHE PARK</b>				
<b>FULLY-INCLUSIVE &amp; ACCESSIBLE PLAYGROUND BLOCK 84, LOTS 16, 18 &amp; 20</b>				
TOWNSHIP OF FREEHOLD ENGINEERING DEPARTMENT MONMOUTH COUNTY, NEW JERSEY 1 MUNICIPAL PLAZA FREEHOLD, NJ 07728				DATE: JAN. 14, 2025
				SCALE: 1"=30'
 <b>MATTHEW J. BRYANT, P.E.</b> TOWNSHIP ENGINEER DATE: 1/14/25				DRAWING: CONCEPT SHEET: 2 OF 2
DESIGNED BY: MJB DRAWN BY: JKT CHECKED BY: MJB				

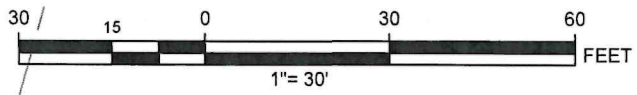

EXISTING BASEBALL FIELD #2

LOT 17

LOT 16

EXISTING SKATE PARK

WOODS

LOT 18

EXISTING PLAYGROUND

EXISTING PAVED PATH